

Sheet Notes

- Existing Site Plan based on existing conditions that were observed on site and existing surveys and county documents.

Paul Cavin Architect LLC

1575 Delucchi Lane
Suite 120
Reno, Nevada 89502

mobile: (775)842-0261
office: (775) 384-6141

www.paulcavindesign.com
paul@paulcavindesign.com

professional seal

PRELIMINARY
NOT FOR CONSTRUCTION

consultant

project

**Truckee Meadows Fire
Protection Fire Station 37**

**Washoe County Community
Services
Reno, Nevada 89502**

revisions

No.	Description	Date

drawn by PF
reviewed by PC
date 11/8/18
project number 18033

drawing name
**Existing
Conditions Site
Plan**

sheet number

A001

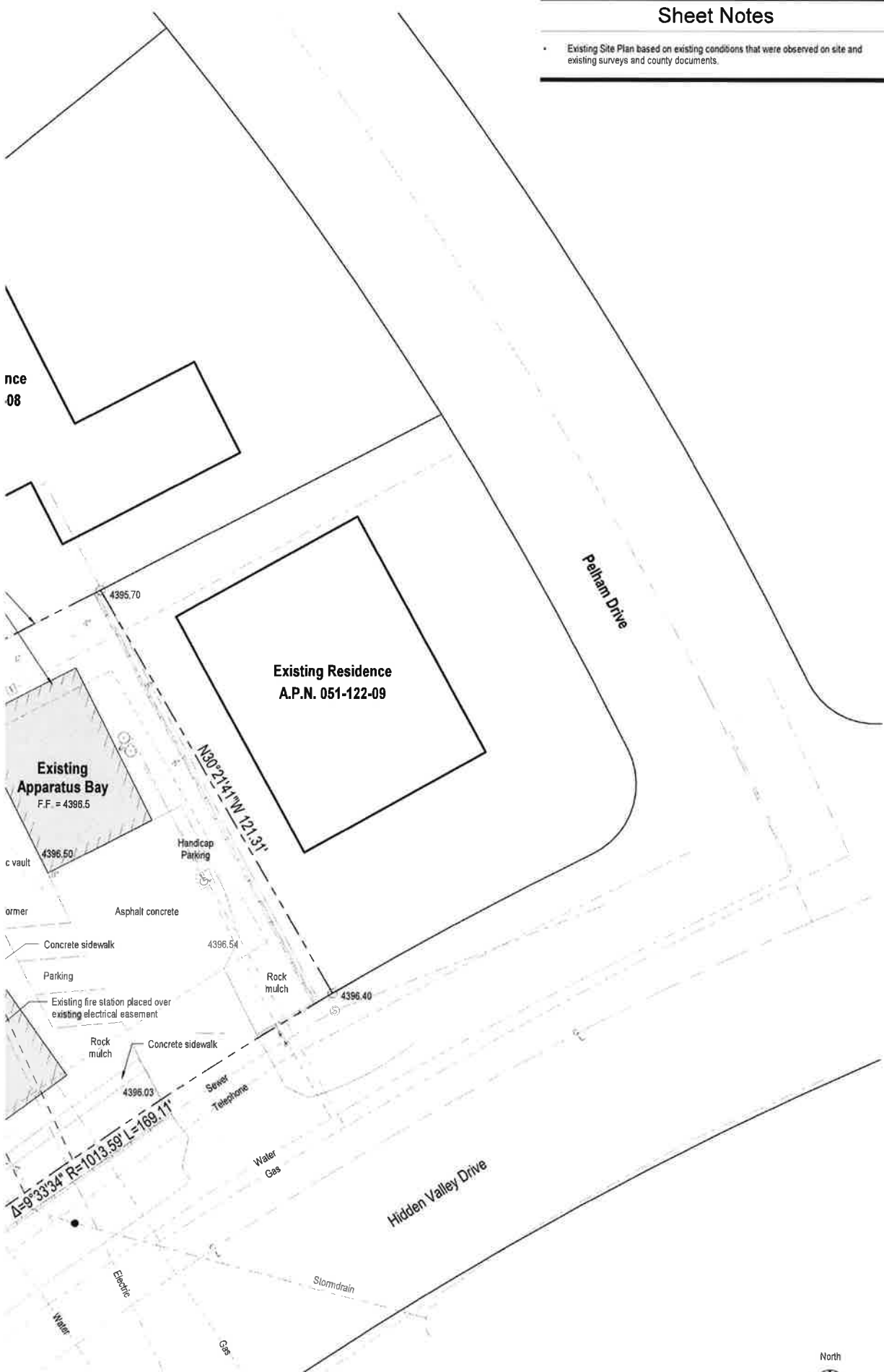

nce
08





**Paul Cavin
Architect LLC**

1575 Delucchi Lane
Suite 120
Reno, Nevada 89502

mobile: (775)842-0261
office: (775) 384-6141

www.paulcavindesign.com
paul@paulcavindesign.com

professional seal

PRELIMINARY
NOT FOR CONSTRUCTION

consultant

project

**Truckee Meadows Fire
Protection Fire Station 37**

Washoe County Community
Services
Reno, Nevada 89502

revisions Δ

No.	Description	Date

drawn by PF

reviewed by PC

date 11/8/18

project number 18033

drawing name

**Site Analysis
Plan**

sheet number

A002



**Paul Cavin
Architect LLC**

1575 Delucchi Lane
Suite 120
Reno, Nevada 89502

mobile: (775)842-0261
office: (775) 384-6141

www.paulcavindesign.com
paul@paulcavindesign.com

professional seal

PRELIMINARY
NOT FOR CONSTRUCTION

consultant

project

**Truckee Meadows Fire
Protection Fire Station 37**

Washoe County Community
Services
Reno, Nevada 89502

revisions

No.	Description	Date

drawn by PF
 reviewed by PC
 date 11/8/18
 project number 18033
 drawing name

**Conceptual
Site Plan**

sheet number

A003

